

Mobile house Apis-1



It is a portable building made from joint mobile modul segments. Due to easy transformation and relocation it can perfectly suit any needs and purposes: family house, weekend summer house, farmsted, student residential house, mobile office, mobile shop, sauna etc.

It is perfect for various weather conditions - comfortable to live in hot summer or in cold winters. Due to new technologies, eco-friendly and energy saving materials this mobile house provides comfort and good life quality.

This is a building for people who value their time and dream about cozy life without any additional worries.

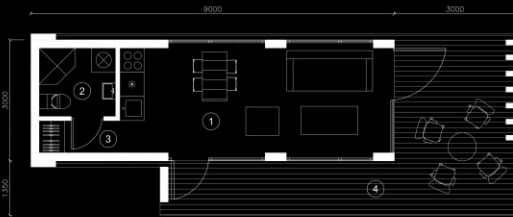

RESIDENTIAL HOUSE PLAN

NR.	PLAN SPECIFICATION	AREA, m2
1	LIVING ROOM	17,50
2	BATHROOM	3,20
3	CORRIDOR	1,60
GROUND FLOOR AREA:		22,30
4	TERRACE	21,30
TOTAL AREA:		43,60

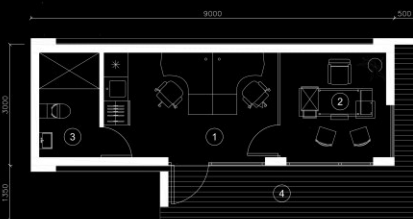

ONE STOREY OFFICE PLAN

NR.	PLAN SPECIFICATION	AREA, m2
1	WORK ROOM	11,20
2	WORK ROOM	6,80
3	BATHROOM	3,90
GROUND FLOOR AREA:		21,90
4	TERRACE	10,00
TOTAL AREA:		31,90

